

| LISÄVARUSTEET | | | | | |
|---------------|-----------------|-----------------------|--------------|--------------|------------|
| OSA | NIMITYS | RUNKO | MITAT | | LVI-NUMERO |
| 1 | KANSI | DU-130 | ∅150.5 | | |
| | | DU-170 | ∅188 | MM: ∅178 | |
| | | PÖNTTÖKAIVO | ∅279 | MM: ∅269 | |
| 2 | NELIÖKANSI | DU-130 | 200 x 200 | | 3316421 |
| | | DU-170 | 250 x 250 | | 3316422 |
| | | PÖNTTÖKAIVO | 350 x 350 | | 3316425 |
| 3 | MATTOKEHÄ | DU-170 PÖNTTÖKAIVO | ∅183 ∅275 | | 3319812 |
| 4 | KOROKERENGAS | DU-130 | H 50 | | 3305231 |
| | | | H 100 | | 3305232 |
| | | DU-170 | H 50 | | 3305233 |
| | | | H 100 | | 3319831 |
| 5 | AKRYYLIKEHÄ | DU-130 | H32 | ∅161 | 3305235 |
| | | DU-170 | H30 | ∅190 | 3305236 |
| | | PÖNTTÖKAIVO | H32 | ∅290 | 3305234 |
| 6 | VESIERISTYSLEVY | DU-130 | ULKO ∅320 | SISÄ ∅149 | 3319822 |
| | | DU-170 | ∅380 | ∅189 | 3319821 |
| | | PÖNTTÖKAIVO | ∅470 | ∅278 | 3319823 |
| 7 | SIVULIITÄNTÄ | | ∅32 x 60 | | 3319801 |
| | | | ∅50 x 60 | | 3319802 |
| 8 | ALTROMATTOKEHÄ | DU-130 | ULKO ∅288 | SISÄ ∅131 | 3305205 |
| | | DU-170 | ∅330 | ∅171 | 3305207 |
| | | PÖNTTÖKAIVO | ∅410 | ∅361 | 3303205 |

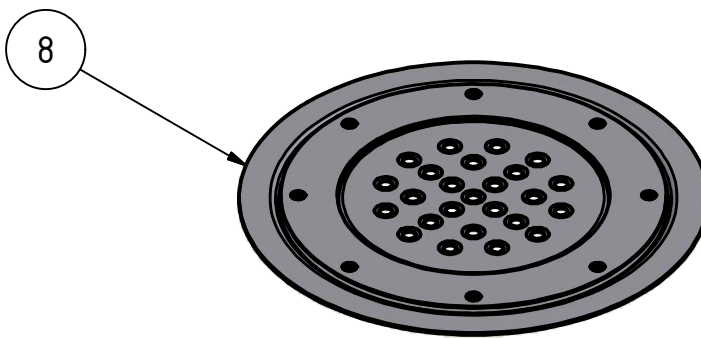
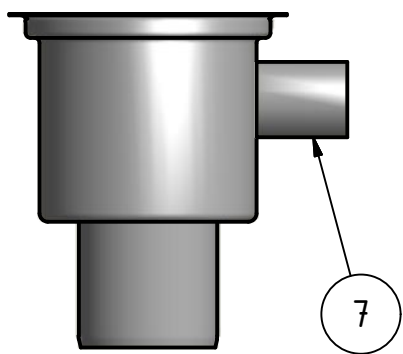
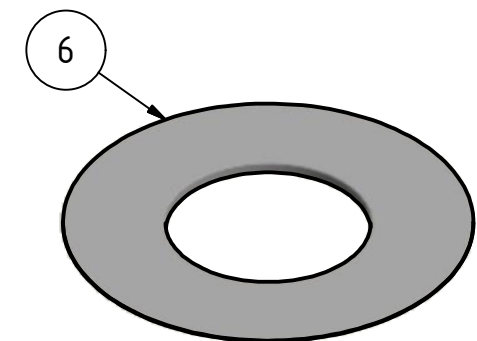
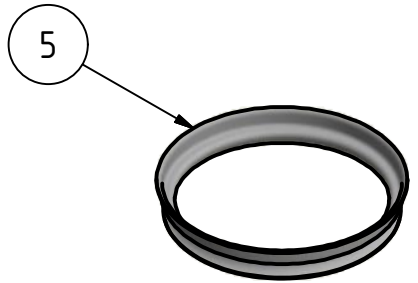
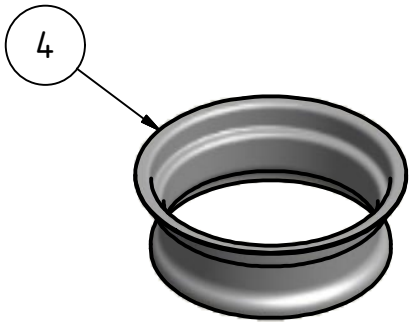
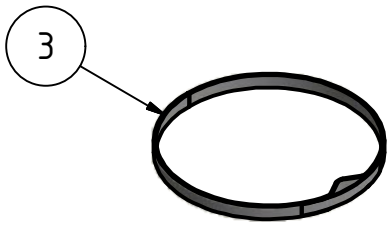
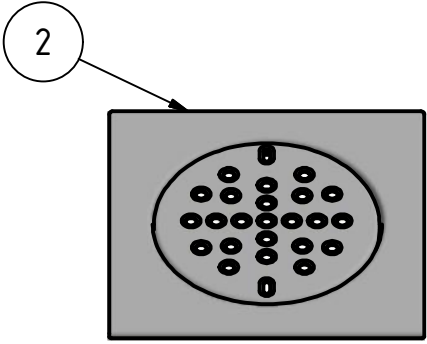
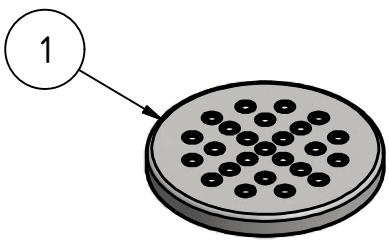

LATTIAKAIVO, VARUSTELUOSAT

| | | | |
|---------------|----------------|-----------------------------|--|
| KOKONAISPAINO | PVM | LIITTYY / PROJEKTI / TYÖNRO | |
| N/A | 3.7.2012 | | |
| MATERIAALI | SUUNNITTELIJA | OSALUETTELO | |
| | | | |
| SIVU | PIIRUSTUS NRO. | REVISIO | |
| 1/1 | | | |